

2024 PA MEDI In-Person Spring Conference

Wyndham Garden State College

AGENDA: DAY 1 – Tuesday, April 30, 2024 | 1:00 – 4:30 pm

12:00 pm – 1:00 pm	Registration & Snacks Available
1:00 pm – 1:05 pm	Welcome Remarks
1:05 pm – 1:35 pm	PA MEDI Helpline Mike Smith, Administrative Services Director Blair Senior Services
1:35 pm – 2:35 pm	PACE Program Becky Lorah, Outreach and Enrollment Manager PA Department of Aging Judy Dooley, R. Ph., Manager Clinical and Community Pharmacy Programs PACE
2:35 pm- 2:55 pm	Break
2:55 pm – 3:30 pm	Senior Medicare Patrol (SMP) Dan Milloy, SMP Outreach and Engagement Manager CARIE
3:30 pm – 4:20 pm	LIFE Erin Slabonik, Director Integrated Care Programs Department of Human Services, Office of Long-Term Living
4:20 pm – 4:30 pm	Networking Activity/Day One Closing Remarks Ikesha Hermantin, PA MEDI Statewide Coordinator PA Department of Aging, Education & Outreach Office

PA MEDI In-Person Spring Conference 2023

Wyndham Garden State College

AGENDA: DAY 2 – Wednesday, May 1, 2024 | 9:00 am – 4:30 pm

9:00 am – 9:05 am	Opening Remarks Ikesha Hermantin, PA MEDI Statewide Coordinator PA Department of Aging, Education & Outreach Office	
9:05 am – 10:45 am	Table Topics 1. STARS 2. Medicare 101s 3. Volunteer Recruitment/Retention	
10:45 am – 11:10 am	Break	
11:10 am – 11:20 am	The 1959 Game Jess Lippert, PA MEDI Regional Coordinator (Central)	
11:20 am – 12:00 pm	Centers for Medicare & Medicaid Services (CMS) Monique Scott, Health Insurance Specialist Office of Program Operations & Local Engagement	
12:00 pm – 1:00 pm	Lunch	
1:00 pm – 2:00 pm	Pennsylvania Health Law Project (PHLP) Erin Guay, Co-Director & Katy McKee, Supervising Attorney	
2:00 pm – 2:15 pm	Break	
2:15 pm – 3:15 pm	Quality Insights Jean Storm DO, CMD, CHCQM Medical Director	
3:15 pm – 4:15 pm	Optimize Aging Linda Shumaker RN, GERO-BC, MA	
4:15 pm – 4:30 pm	Conference Wrap-Up and Closing Remarks	

Wyndham Garden State College Map

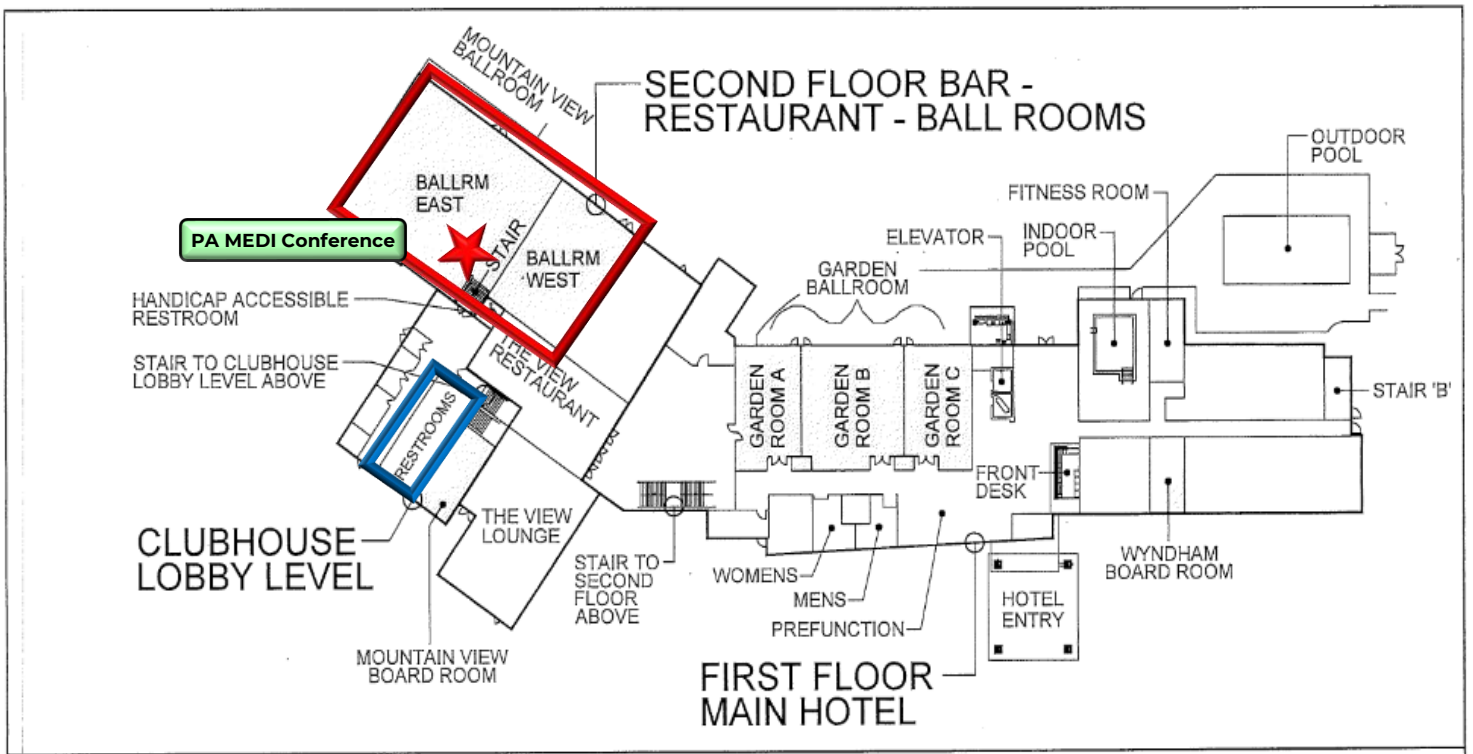

Meeting Room Location (Mountain View Ballroom) outlined in RED.
The Restroom Location is outlined in Blue.